

THE SEVENTEENTH INTERNATIONAL CONFERENCE
ON LEARNING

Hong Kong Institute of Education
Hong Kong
6-9 July 2010



Learning
www.LearningConference.com

Dear Delegate,

Thank you for participating in the Seventeenth International Conference on Learning! We are pleased you will be joining us in Hong Kong at the Hong Kong Institute of Education and hope you are looking forward to coming together with colleagues and members of the Learning community this July.

In preparation for the conference, we have put together some information that we hope will prove useful to you as you begin to prepare for the conference and your arrival in Hong Kong. In this document, you will find information such as transportation information, a map of the Hong Kong Institute of Education, conference registration information, presentation information, and paper and journal information.

This packet is a starting point for your preparations, and we realize you may have some additional questions after reviewing the material here. For any questions that remain, please contact the conference secretariat at support@thelearner.com.

We hope your planning goes well, and we look forward to meeting you in Hong Kong!

Best regards,

Jenna Stoia
Learning Conference Producer

For the Seventeenth International Conference on Learning

TABLE OF CONTENTS

- I. Letter from Secretariat
- II. Maps
 - Locating HKIED in the Tai Po, New Territories
 - Layout of HKIED
 - Floor plan for the Learning Conference
- III. Travel Information
 - Transportation
 - Travel from the Airport
 - From the Hotels to HKIED
- IV. Conference Information
 - Registration
 - Registration Desk Location and Hours
 - Special Instructions
 - Presentation Information
 - Equipment
 - Program
 - Online Presentations
 - Activities and Extras
 - Tours
 - Dinner
 - Paper and Journal Information
 - Submission Deadline and Further Information
 - Peer Review Process

MAPS

MAP OF HONG KONG INSTITUTE OF EDUCATION WITHIN THE TAI PO NEW TERRITORIES

Location map of the HKIEd
香港教育學院位置圖

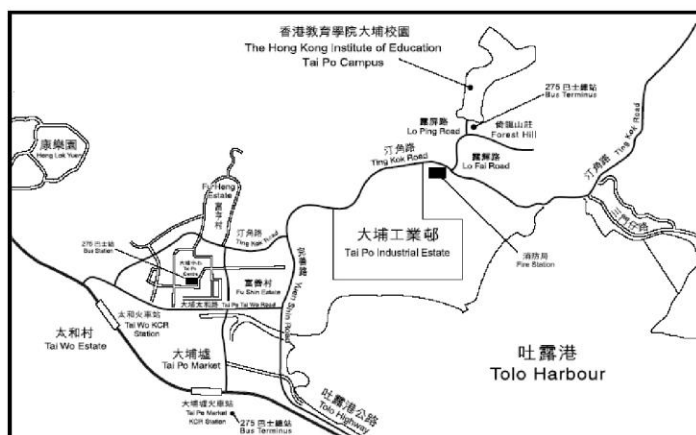

MAP OF THE HONG KONG INSTITUTE OF EDUCATION

The Hong Kong Institute of Education
Tai Po Campus
香港教育學院大埔校園



LAYOUT FOR THE CONFERENCE ROOMS AT THE HONG KONG INSTITUTE OF EDUCATION

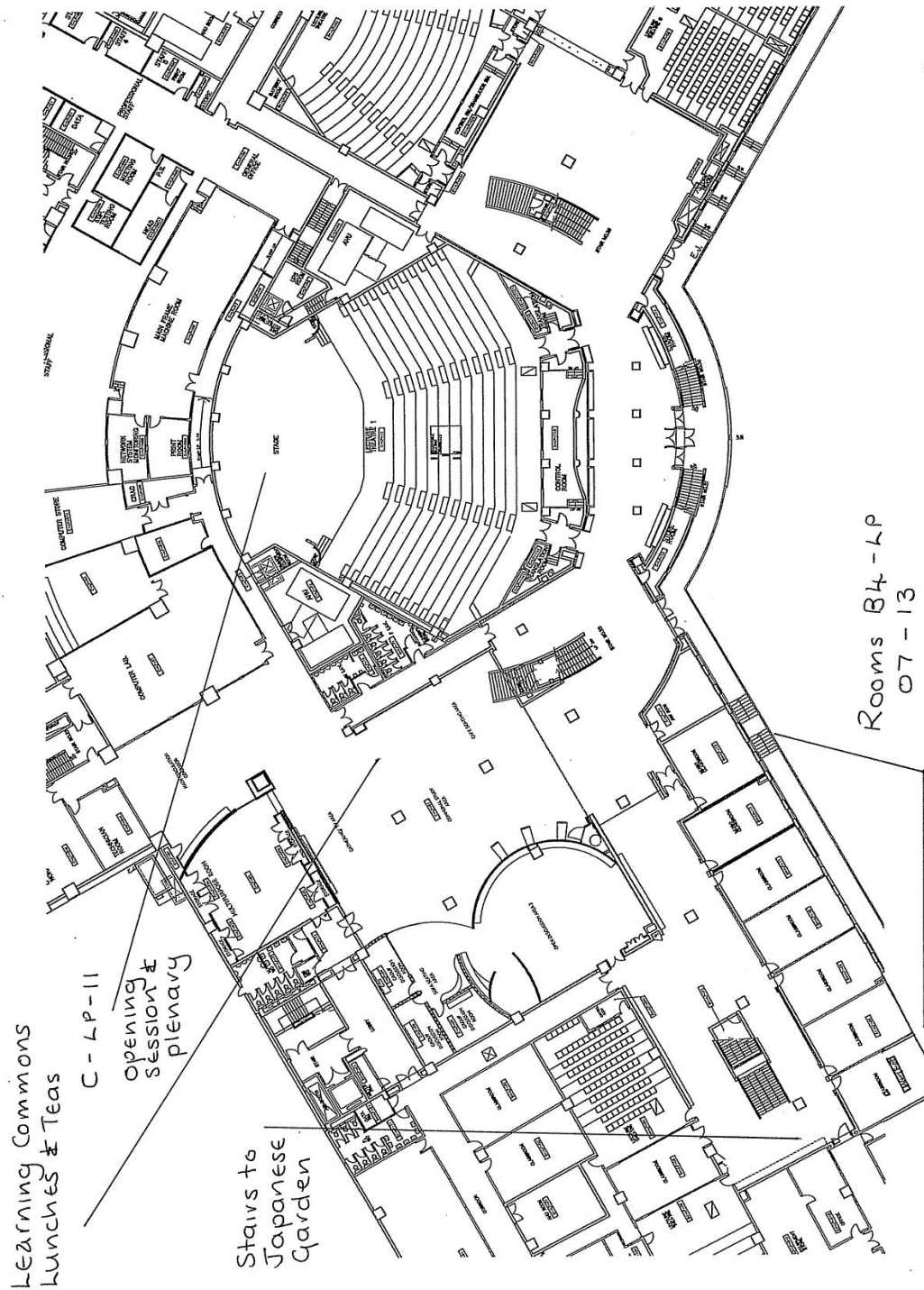

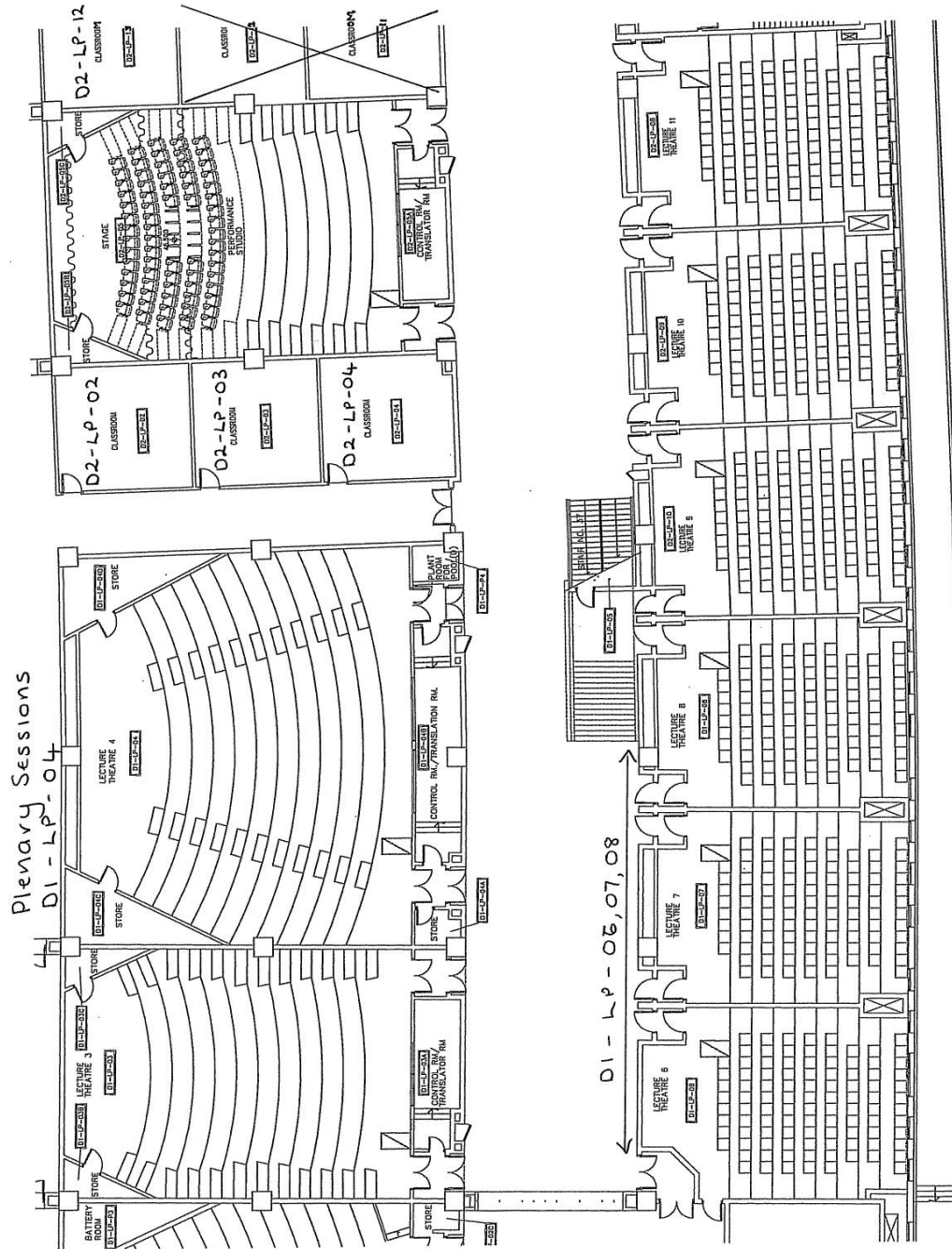

TRAVEL INFORMATION

TRANSPORTATION FROM THE AIRPORT TO VARIOUS HOTELS

You can access the Airporter Express train by walking immediate beyond the Customer Service Centre in the Arrival Hall A & B and straight onto the train platform. The train departs every 10 mins. It is a very convenient and economical means to travel to either Hong Kong Island (25 mins) or to the Kowloon side of Hong Kong (20 mins) – Kowloon Station is the destination for hotels in Tsim Sha Tsui – where the *Holiday Inn Golden Mile* and *The Salisbury YMCA* hotels are located. Both are serviced by the Complimentary Airport Express Shuttle Service to/from hotels to the train stations.

More Information is available at:

<http://www.mtr.com.hk> (or pick up the leaflet in the luggage collection hall along with other tourist information leaflets).

YMCA guests can alight at the Kowloon Hotel/Peninsula Hong Kong hotel stop as the YMCA is right next door. Alternatively most Kowloon hotels are just a short taxi ride from the Kowloon Station.

[Kowloon & Hong Kong Airport Express stations also offer airline check-in facilities for your departure. You simply show your Airline ticket and an Airporter Express ticket, and you will be able to check your luggage in up to 12 hours in advance of your departure time. You also receive your boarding pass. This leaves you free of luggage for the rest of the day/evening and time to do last minute things in Hong Kong without your luggage. You simply return to the Airport Express Station to catch the Airporter Express in time for your flight].

For conference participants making their way from the airport to the *Hyatt Regency* or the *Royal Park* hotels in Shatin (sometimes written as Sha Tin), in the New Territories, the alternatives are either a bus (very reasonably priced) from the airport or a taxi (fine if you can share the cost between two or three).

Reasonably priced buses are A41 for \$21HKD or E42, which is a little slower for \$13.60HKD (up to 60-80 mins to reach your destination but you certainly get to see a good view of Hong Kong as you drive in, especially if you get a front row seat on the top deck) – alight at the Shatin bus exchange for both hotels. English announcements are made for each stop.

Participants heading to *The Hyatt, in Shatin* will need to take a taxi from a taxi rank right outside the bus exchange depot and ask to be taken to the Hyatt Hotel.

Show the Chinese address to the taxi driver:

香港沙田凱悅酒店

中國香港新界沙田澤祥街18號,

電話： +852 3723 1234 +852 3723 1234

傳真: +852 3723 1235 +852 3723 1235

電子郵件： hongkong.shatin@hyatt.com

地圖與路線指引)

Participants staying at the *Royal Park* hotel can take the short walk to the hotel from the bus exchange. Go to the hotel's website for a diagram of its location.

Airport buses all look the same except for the number which indicates the destination – please see below.

To access buses and taxis at the airport walk beyond the Customer Service Centre and down the internal ramp from the arrival halls to the exit where it opens up on the left to bus bays where signposts showing each bus' departure position.

On the right is the official taxi rank. Avoid offers of a ride to your destination from unofficial persons who may approach you as you exit the Airport via the ramp. If travelling to Hong Kong Island or Kowloon – take a red taxi (40-50 mins). For destinations in the New Territories – e.g. Tai Po (where the conference venue is) (60/90 mins) or Shatin (40/60 mins) for the Royal Park or the Hyatt hotels – take a green taxi – although a red taxi can travel to New Territories destinations as well.

Check prices for taxi rides to various destinations at

<http://www.hongkongairport.com/eng/transport/to-from-airport/taxi.html>

TRANSPORTATION FROM YOUR HOTEL TO THE HKIED

For your convenience the conference organizers will run buses from the two main hotels:

To Hong Kong Institute of Education (HKIEd) at Tai Po Campus from the (6th – 9th July)

1. A bus will depart from YMCA at Salisbury Road, TST at 7.45 am
2. Another bus will depart from YMCA at Salisbury Road, TST at 8:00 am
3. A bus will depart from Royal Park Hotel Shatin at 8:15 am
4. Another bus will depart from Royal Park Hotel Shatin at 8:30 am
- The buses that depart from The Hyatt Shatin are the same ones that depart from the Royal Park. Hence they will depart 10 minutes later at the The Hyatt*
5. A bus will depart from Hyatt Shatin at 8.55
6. A second bus will depart from The Hyatt Shatin at 8.40

From HKIEd to your accommodation (6-9 Jul)

A bus will depart at 6:00 pm to take participants to The Hyatt & Shatin Royal Park

A bus will depart at 6:00 pm to take participants to the YMCA at Salisbury Road, TST

A second bus will depart at 6:30 pm take participants to The Hyatt & Shatin Royal Park

A bus will depart at 6:30 pm to YMCA at Salisbury Road, TST

CONFERENCE INFORMATION

REGISTRATION DESK LOCATION AND HOURS

The registration desk will be located at the base of the stairs. Follow the stairs down to the lower podium and the registration desk will be right in front of you and signs will indicate the way. The Learning Conference will begin on 6 July at 9:30 and on 7, 8, and 9 July at 9:00. Each day, the conference will end before 18:00. The registration desk will open each day an hour prior to the start of the conference and will remain open each day for the duration of the conference.

PRESENTATION INFORMATION

Equipment:

Each parallel session room is supplied with a projector and a laptop for your convenience. Please be sure to bring a thumb drive containing your presentation.

Program:

The current draft can currently be found online at <http://l10.cgpublisher.com/program-detail.html>. In addition to this, you will receive a program booklet at the conference with the final schedule for the plenary and parallel sessions.

Online Presentations:

Online Presentations can be viewed through our YouTube Channel at <http://www.youtube.com/group/thelearner>.

These presentations are made by both our virtual registrants and our in-person participants. Whether you are presenting at this conference, or are a virtual participant, we encourage all participants to present on the Learning Conference YouTube Channel. Here are two suggestions:

1. Record a video of your presentation before or after the conference, or ask a colleague to record a video of your presentation at the conference, and then submit it to our YouTube channel.
2. Create a PowerPoint presentation with voice-over before or after the conference, or record the audio of the presentation at the conference, then link this to the PowerPoint presentation.

These presentation recordings will be published to YouTube with a link to your session description on the conference website, and (if your paper is accepted to the journal), a link to the abstract of your paper on the journal website.

For instructions on how to create and upload these presentations, visit the conference website at <http://thelearner.com/conference-2010/online-presentations/>.

EXTRA ACTIVITIES

Conference Dinner

Wednesday, 07 July 2010-7:00 PM (19:00)

US \$ 75.00/per person

The Conference Dinner will be held at Serenade Chinese Restaurant located on Salisbury Road on the 1st floor of the Hong Kong Cultural Center. This authentic Chinese restaurant offers views of Victoria Harbour in a bright and cheerful setting. Your meal will consist of 8 courses plus beer and wine. This will be a memorable dining experience during your stay in Hong Kong.

Please note that on Wednesday 7 July, two buses will depart from HKled for the conference dinner at TST at 6.00 pm.

There is still room at the dinner venue but space is limited. If you are still interested in participating, please be sure to contact us at support@thelearner.com immediately in order to register and pay for the dinner.

Conference Tours

Old and New Hong Kong Walking Tour- Tuesday 06 July 2010-6:00 PM (18:00)

US \$ 30.00/per person

Join us on this walking tour as we view the contrast between the old and the new of Hong Kong. Hong Kong offers a wealth of architectural influences and styles just waiting to be discovered. During this walk through the heart of the central business district, guests will come to understand the evolution of the city through its buildings.

Thrusting skyward in dramatic contrast to these historical structures are Hong Kong's many glass and steel monuments to modernism. Designed by some of the world's most renowned architects, they are vital to understanding the evolution of building styles and the way Hong Kong's urban architecture has changed during the past century.

Local Night Market Tour -Thursday, 08 July 2010-6:30 PM (18:30)

US \$ 30.00/per person

This tour begins with a drive along the famous Nathan Road, the Golden Mile of Hong Kong, with its renowned neon signs. Then we will stroll around the famous open-air market on Temple Street.

Temple Street is an amazing shopping sight, featuring rows of brightly lit stalls selling an astonishing variety of inexpensive items for men and women. You will be able to purchase just about anything you want at a very reasonable price. Fortune-tellers cluster at the Yau Ma Tei end of the street, as do Chinese opera enthusiasts offering impromptu performances.

****Please note that space is limited for the tours. If you are interested in attending either tour, please contact support@thelearner.com .**

PAPER AND JOURNAL INFORMATION

Submission Timeline:

Whether you participate in the conference as a virtual registrant or as an in-person delegate, you are invited to submit a paper for consideration in *The International Journal of Learning*. The final date for submitting your paper for consideration is 09 August 2010. This will guarantee that your paper is reviewed through our one way blind refereeing process.

More information on submitting your paper to *The International Journal of Learning* can be found at <http://thelearner.com/journal/publish-your-paper/> . At this site you will find extensive information about the submission process, author guidelines, the editorial quality of our journal, and the publications process. This information will also be available in the conference program.